



## K150 Direct Plumb Kit Installation Quick Start Guide

**NOTE:** The K150 Brewer is designed to fill in 90 seconds. Depending on water pressure and voltage variations the brewer may time out during fill. If this occurs just flip the on/off switch – restarting the brewer.



1

Make sure to disconnect the brewer from AC power supply and drain the internal Hot Water Tank if previously filled.



2

Remove the Cold Water Tank from the Brewer.



3

Turn the Brewer on its left side and remove the 2 highlighted screws (Screw A)- reserve the 2 screws for later use when attaching the Direct Plumb Kit.

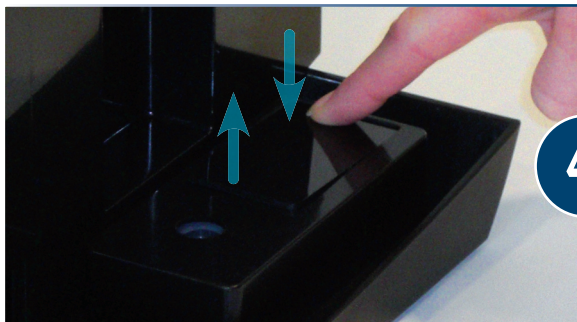

4

Turn the K150 Brewer right side up. Press on one end of the Base Plate to release and remove.

OVER

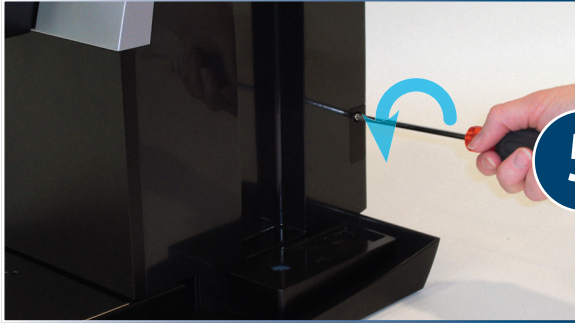

5

Remove the Connector Cover on the side of the Brewer with a screw driver- Reserve the screw (Screw B) for later use when re-attaching the Connector Cover.

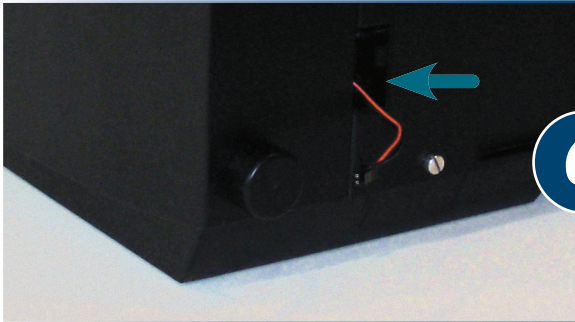

6

Set the K150 Direct Plumb Kit on the Base and plug-in the electrical connection from the Direct Plumb Kit to the Brewer.

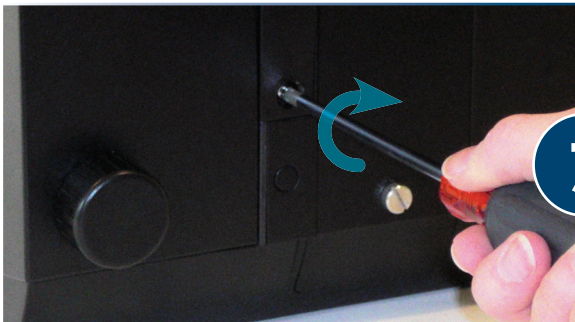

7

Replace the Connector Cover with a screw driver and the reserved screw (Screw B). Screw in the Connector Cover until it is flush with the side of the unit.

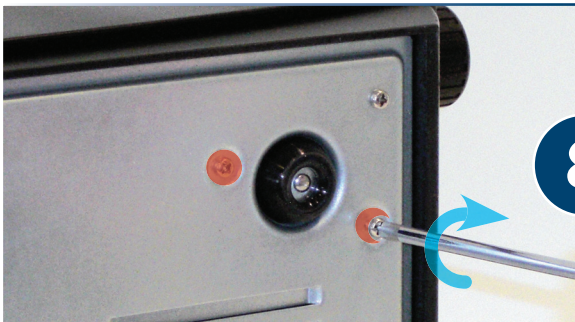

8

Carefully turn the brewer on its left side and re-insert the 2 reserved screws (Screw A), securing the Plumb Kit to the Base.



9

Connect the K150 to AC power and a filtered water supply. Turn the Brewer "On".



10

The Brewer should take 90 seconds to fill. However, depending on water pressure and voltage variations the brewer may time out during fill and shut down. This is normal. If this occurs just flip the "On/Off" switch, the brewer will re-start and it will complete the fill.